

This drawing is provisional and subject to our reconfirmation and/or revision without notice.

xxx T/PW 6M17 (01) xxx (2100 1121 ) 01-01-11

DH3~DH4= 22279 (±20)  
DH5~DH6= 22287 (±20)

Coordinates

Mark	X	Y	R
GM	0	0	
DH3	10507	3700	
DH4	-10507	-3700	
DH5	-8799	6900	
DH6	8281	-7500	
b1	8032	7877	500
b2	8624	7608	150
b3	10099	5501	150
b4	10149	4853	500
b5	7809	-8098	500
b6	7595	-8688	150
b7	5416	-10145	150
b8	4768	-10190	500
b9	-8032	-7877	500
b10	-8624	-7608	150
b11	-10099	-5501	150
b12	-10149	-4853	500
b13	-7809	8098	500
b14	-7595	8688	150
b15	-5416	10145	150
b16	-4767	10190	500

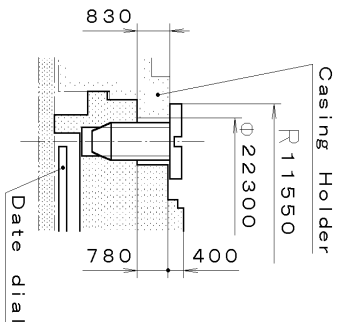
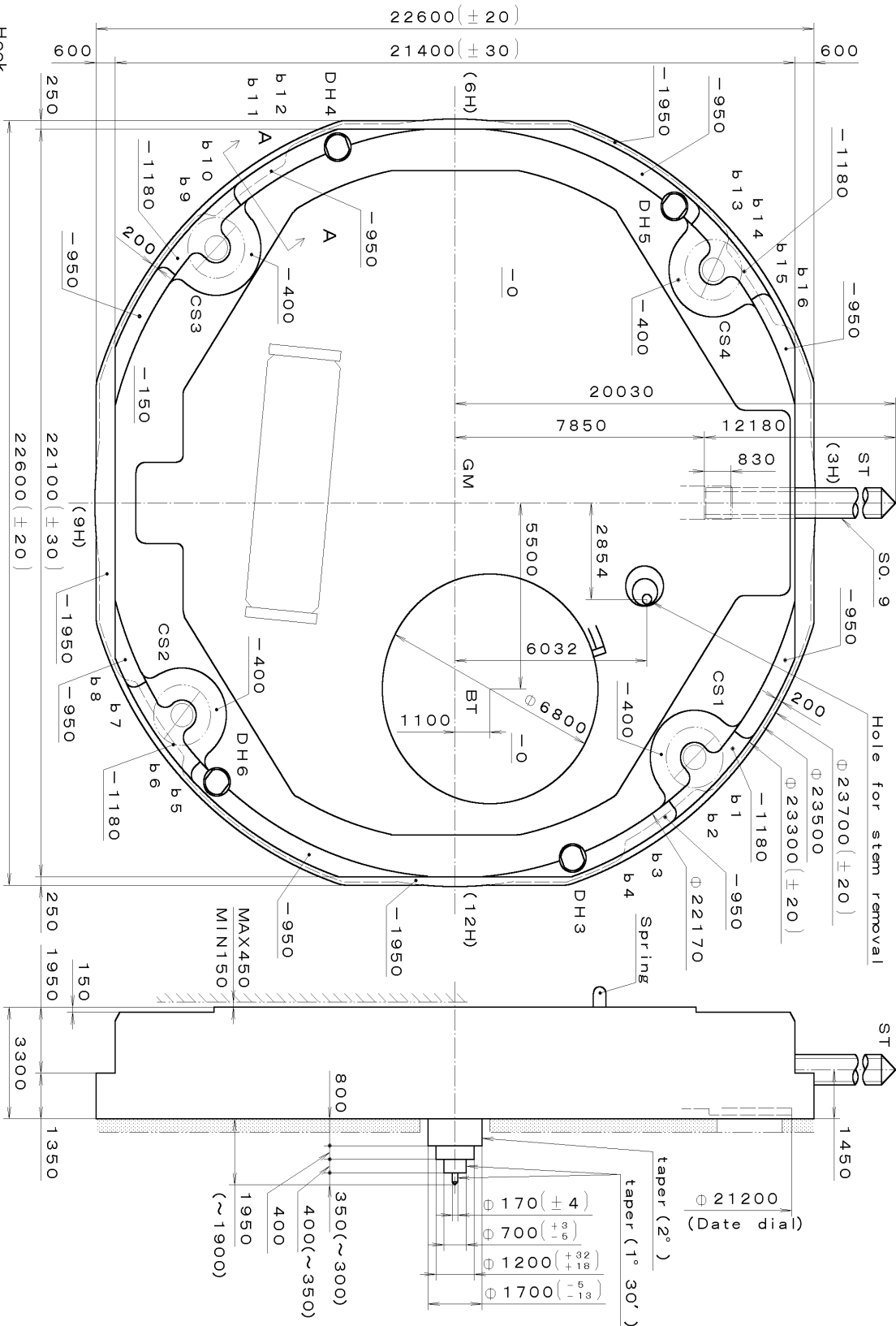

Section CS1~4

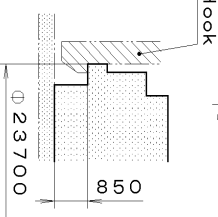

Section A-A

Material	Quantity	Unit	Scale	Cal. No. :
Material		1/1000 mm	8:1	6M17
Heat Treatment				
Hardness				
Plating				
General Tolerances				
Dimensions				
Angles				
Name : T. Hiruta				Parts :
Drawing No. : 6M17C000				Frame for Case

This drawing is provisional and subject to our reconfirmation and/or revision without notice.

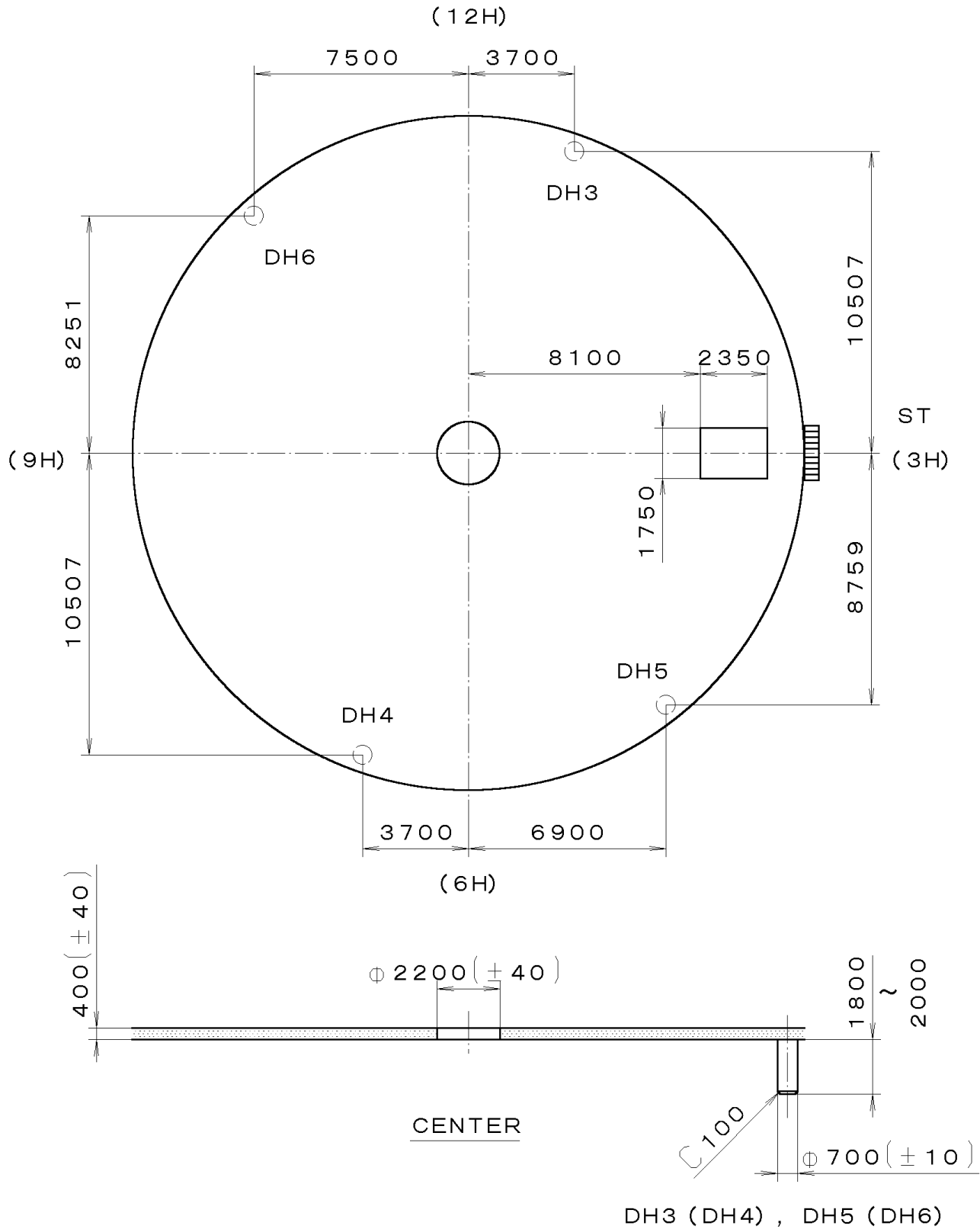

\*\*\* T I P W (01) \*\*\* (2100 1121) 01-01-11

7		Quantity		Cal. No. :	6M17-00A
6		Unit	1/1000 mm	Parts:	
5		Scale	5:1	Name:	Indications for Dial
4		Date		Drawing No. :	6M17D000
3		Drawn			
2		Checked	T. Hiruta		
1		Approved			
<b>Material</b>					
Heat Treatment		General Tolerances			
Hardness		Dimensions			
Plating		Angles			

DH3 (DH4) , DH5 (DH6)

This drawing is provisional and subject to our reconfirmation and/or revision without notice.

065-379 (01) \*\*\* (2100 1121) 00-06-23

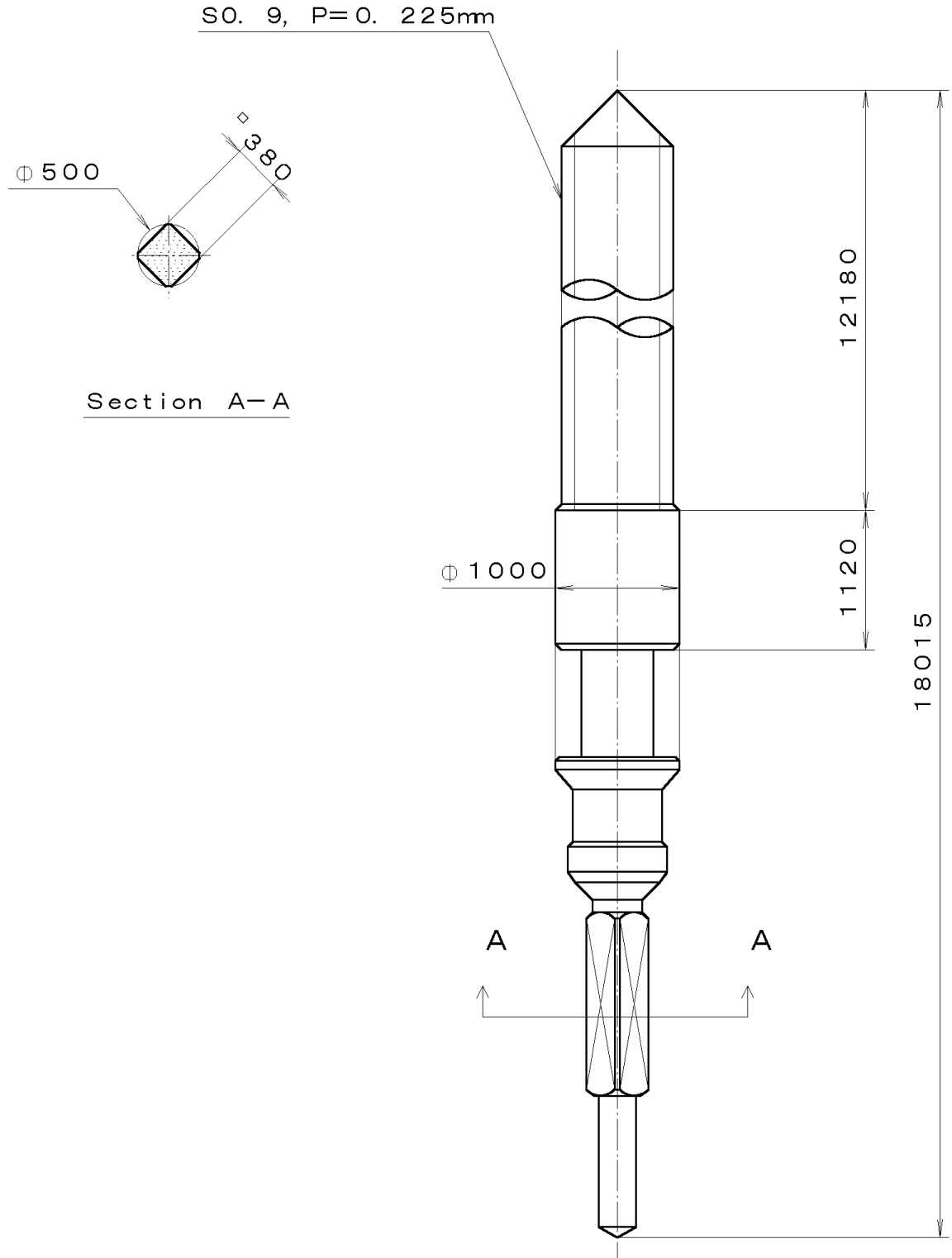

7		Quantity		Cal. No. :
6		Unit	1/1000 mm	Parts:
5		Scale	20:1	
4		Date		
3		Drawn		Name:
2		Checked	T. Hiruta	
1		Approved		SETTING STEM
Material				Drawing No. : 3790S000
Heat Treatment		General Tolerances		
Hardness		Dimensions		
Plating		Angles		